

Andreas Krauth, Urs Kumberger,  
Marina Nazarova, Mariya Voronkova

## Hermitage 2.0

### Hermitage 2.0

Petersburg is the cultural centre of Russia. The Hermitage is the cultural centre of St. Petersburg. The site of our project is located at the opposite of the Hermitage at the “water square” of Neva. Many important buildings of the city are located around that square. The area of the project has potential to become another interesting point at that waterfront.

The idea is to offer a contemporary structure like Hermitage, the Hermitage 2.0. There is no museum of modern art in St. Petersburg.

The main concept is a building complex of high density filled with completely different uses. Its central situation is attractive for cultural uses, science, a hotel and other very public functions. Important topics are public urban space, open democratic building structures and the connection of the area with the city and its people. We worked with three definitions of public: super public, connecting public, specific public. Hermitage 2.0 should refer to surrounding urban spaces and important buildings to create some axis and squares. Another topic of our work is how to react at the waterfront and at the crowded street next to the site.

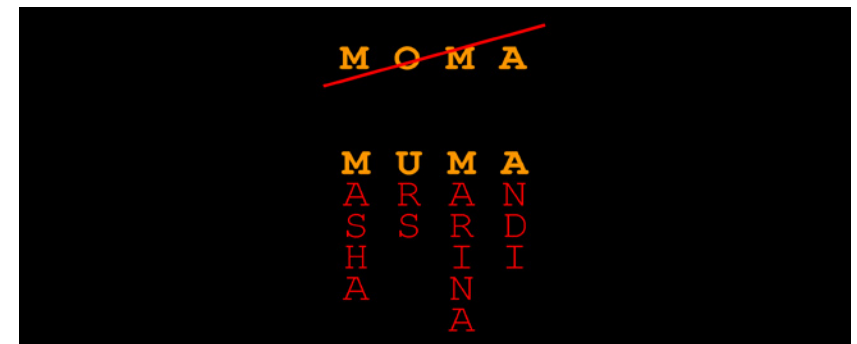



analysis context

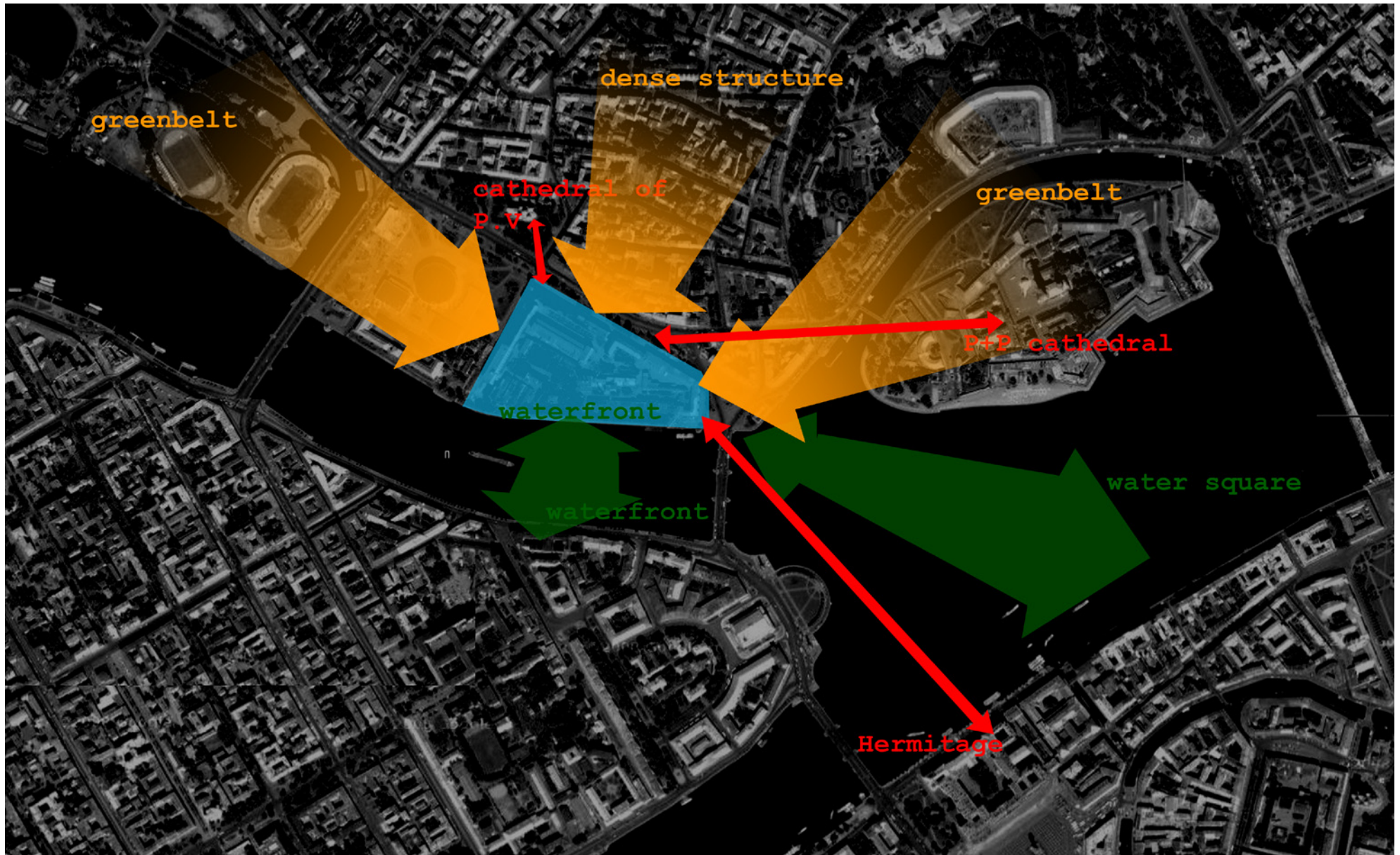

analysis context

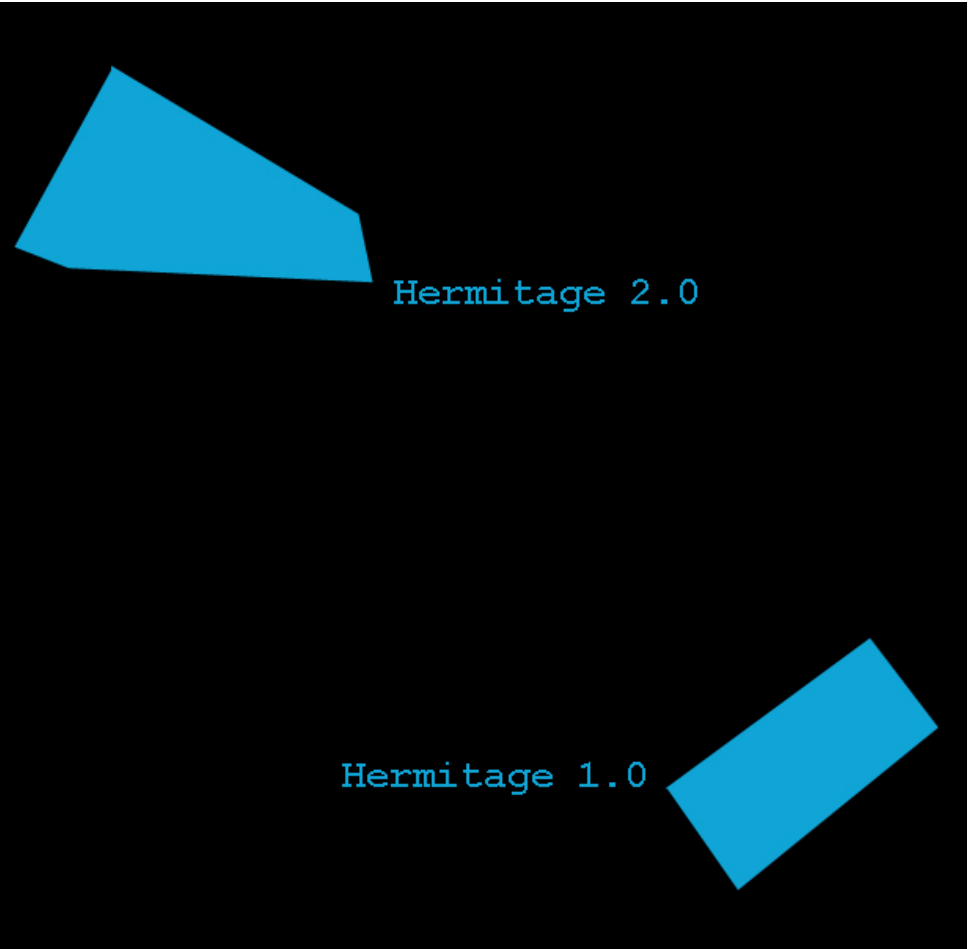
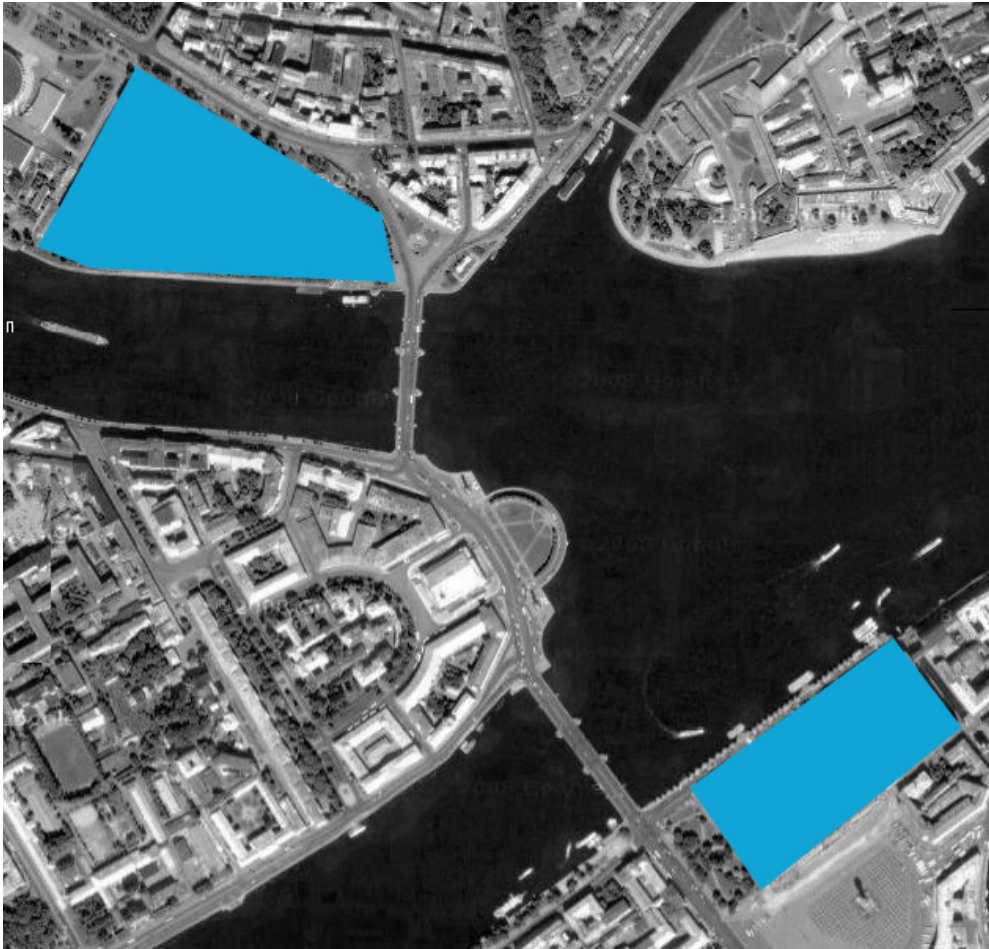

Hermitage 2.0

Hermitage 1.0

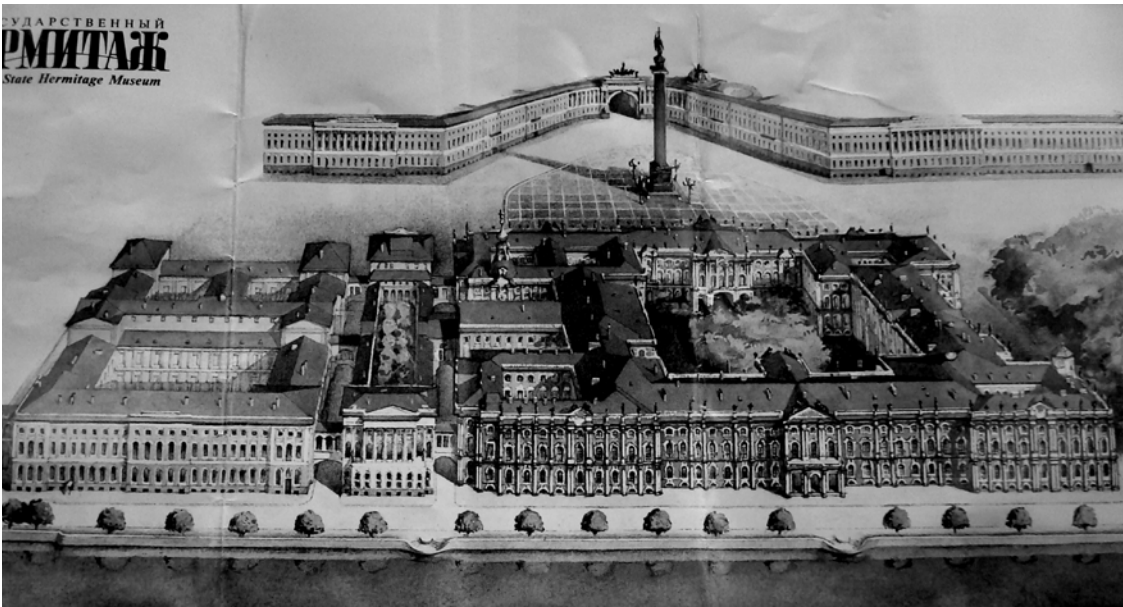

image profile



user profile



public Hermitage



site

hyper connected

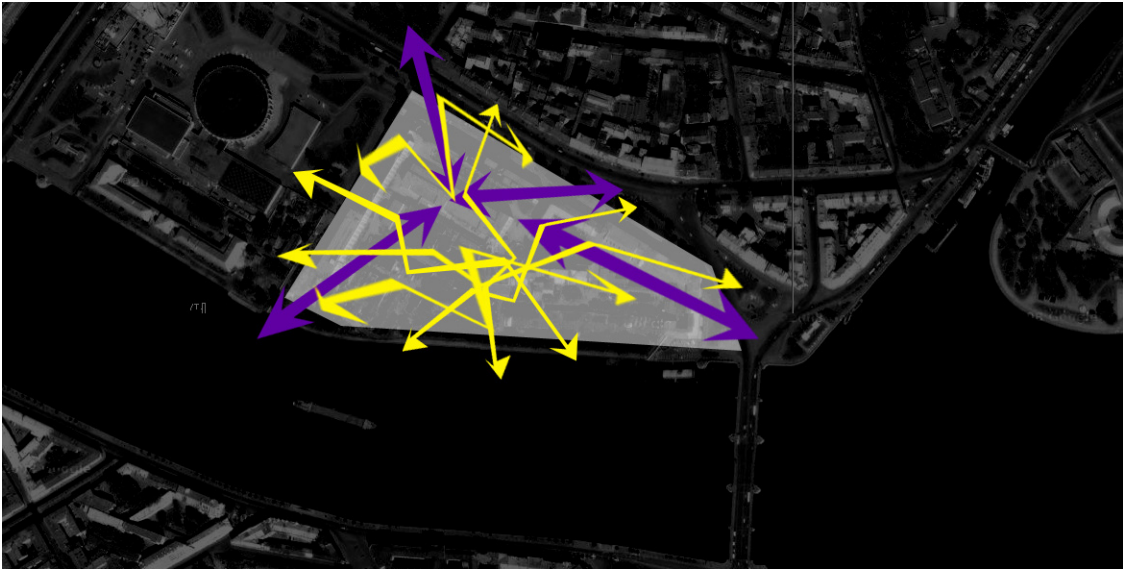

two borders

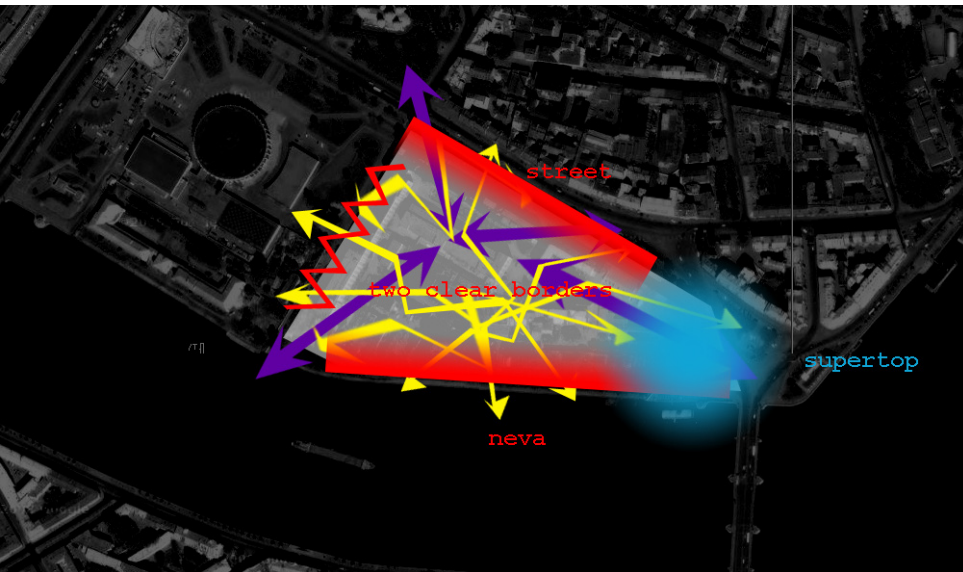
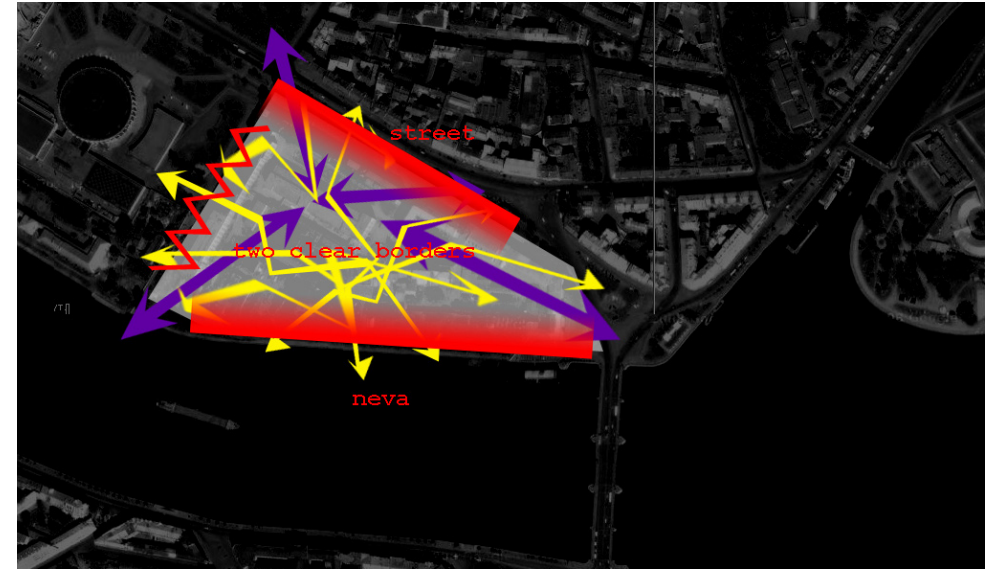

supertop

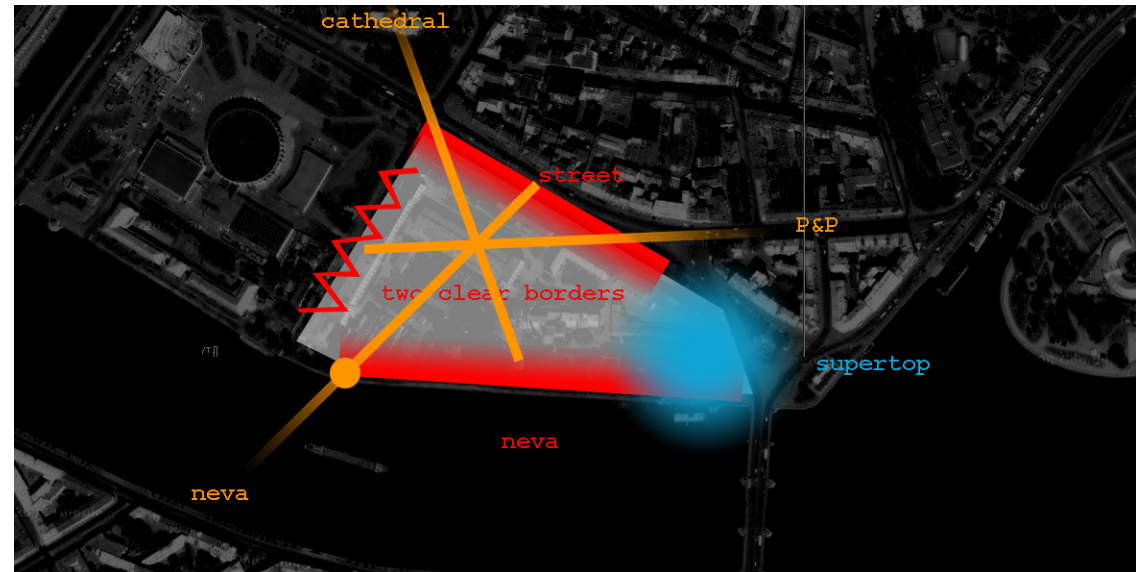

axis

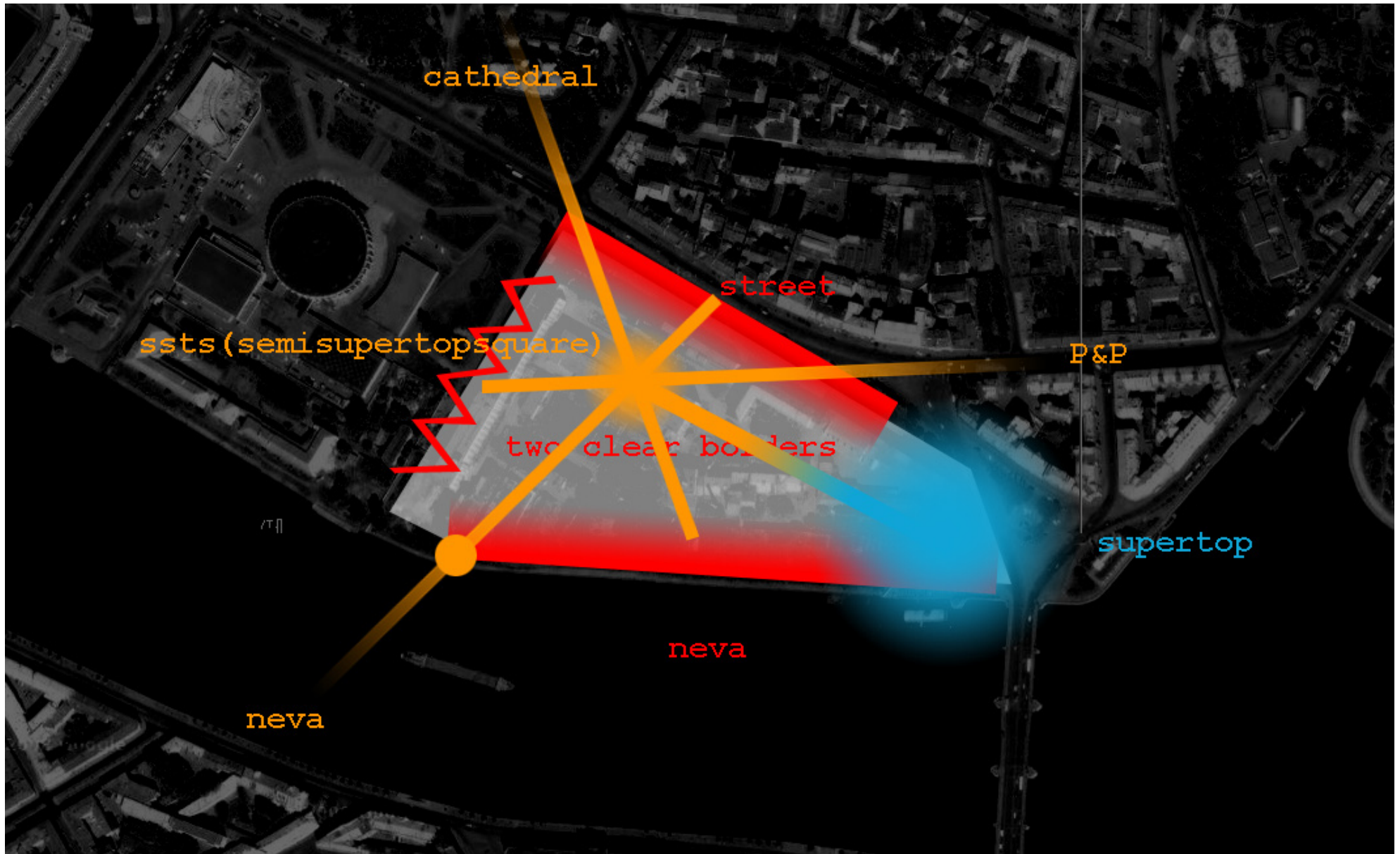

second supertop





### superpublic

museum of modern art  
shopping  
neva boulevard  
main squares  
green roof promenade  
cinema

### connecting public

restaurant  
cafe  
hotel bar  
internal yards  
freetime activity  
sports  
information centre  
club

### specific public

hotel  
dormitory  
university  
library  
conference centre

public zones

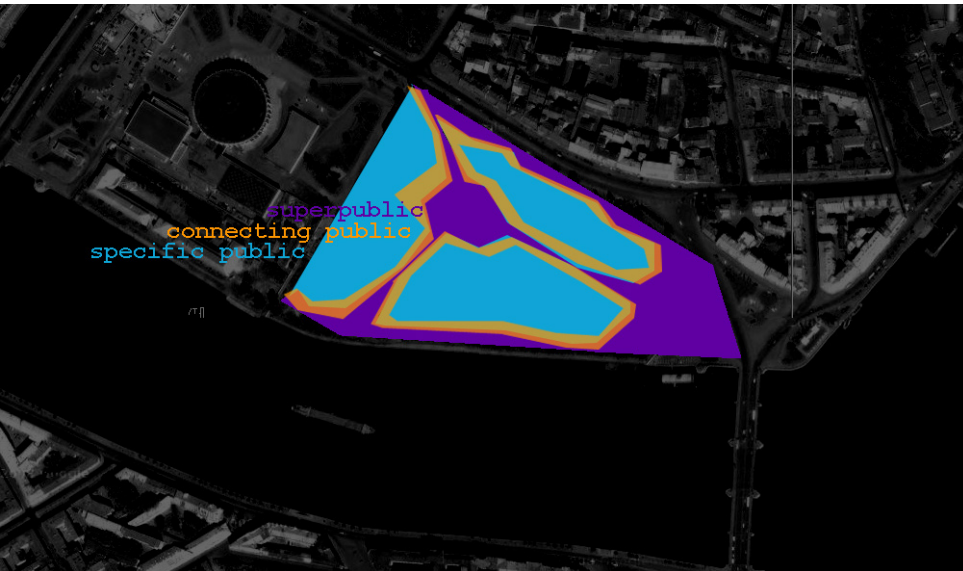

uses

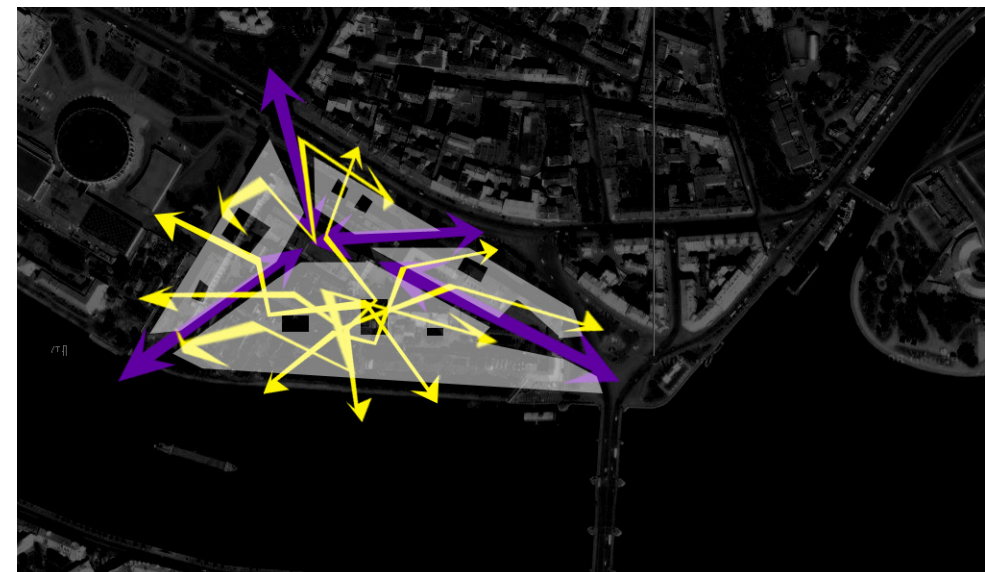
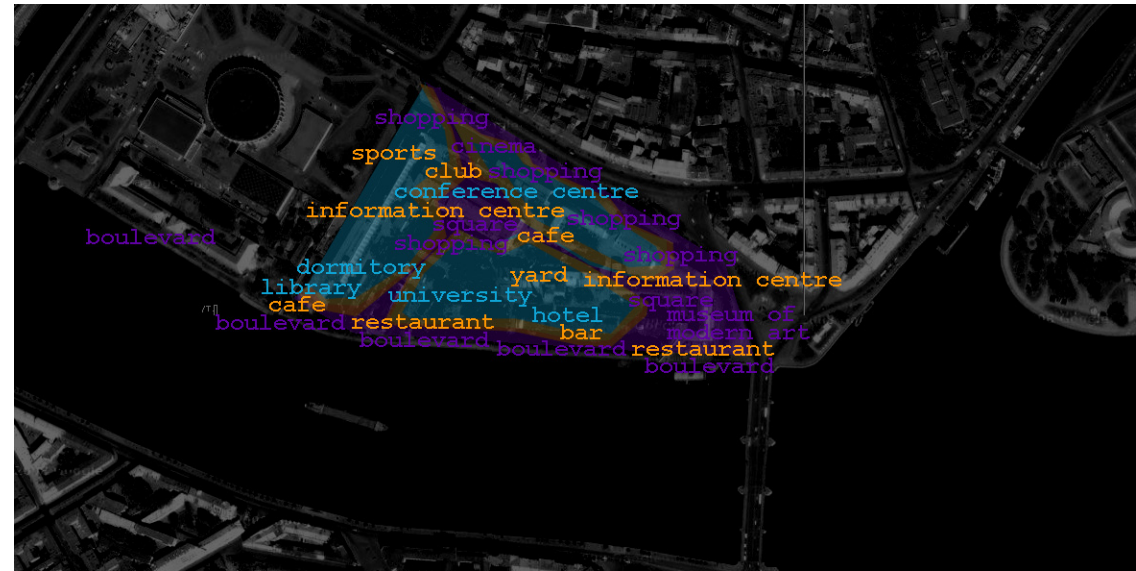

structure



two layers of circulation

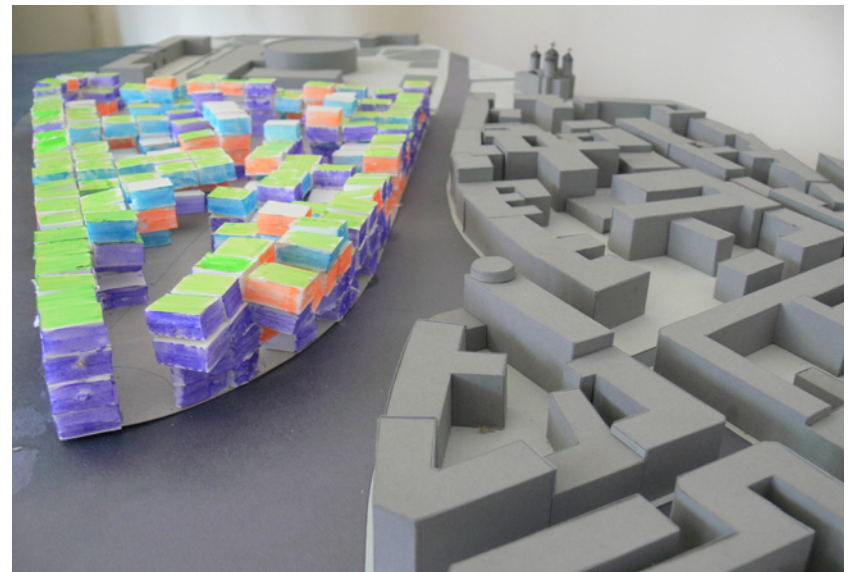

model photos

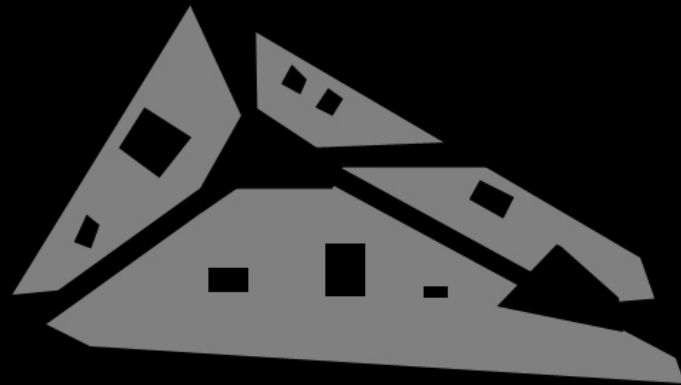

Hermitage 2.0

Hermitage 1.0

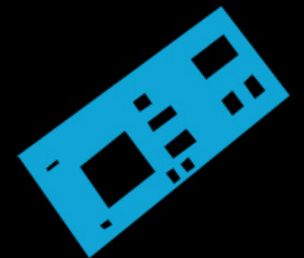

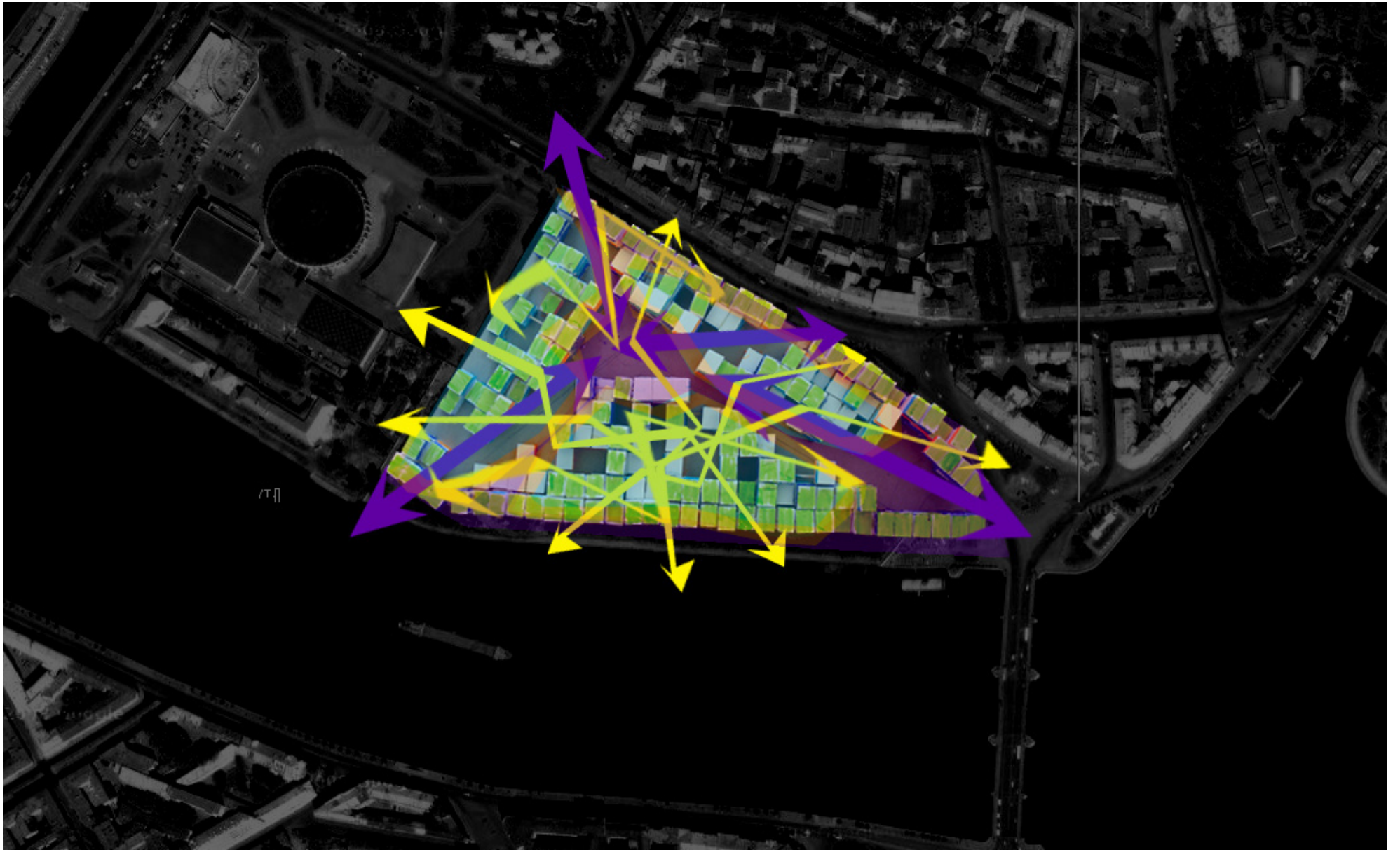

Hermitage 2.0, a hyper connected multi functional mega structure